

# DUMBWAITER

DUMBWAITER

## SPECIFICATIONS

- Same guides for cabin and counterweights.
- Pulley  $\Phi 250$
- Wire ropes  $\Phi 6$
- No safety device

## SPECIFICATIONS

- LOAD : 50 – 150 Kg
- (200 Kg after study).
- Speed: 0,37 m/s (0,25 & 0,48 m/s)
- Travel: 'up to 35m

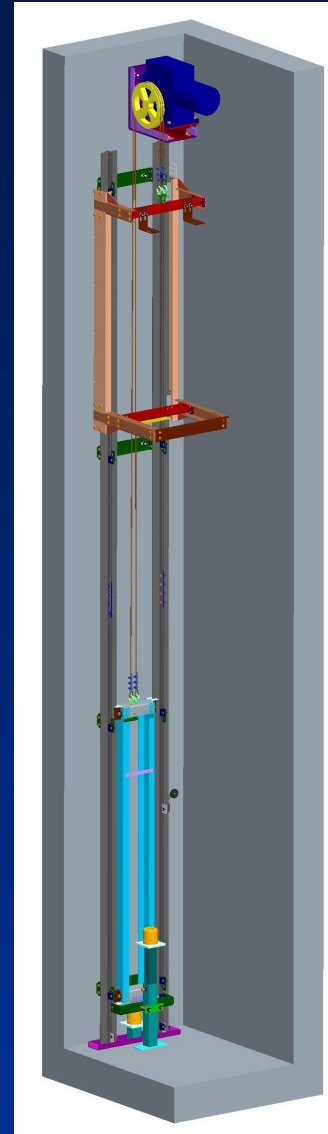

DUMBWAITER

# MACHINE

- 
- (AC1)
  - Power = 1,1 KW  
(0,7 KW for 0,25 m/s)
  - Load max = 200 Kg
  - Speed = 0,37 m/s  
(0,25 m/s & 0,48 m/s)
  - Static load = 650 Kg
  - Ratio = 1/53  
(1/41 for 0,48m/s)
  - 2 wire ropes

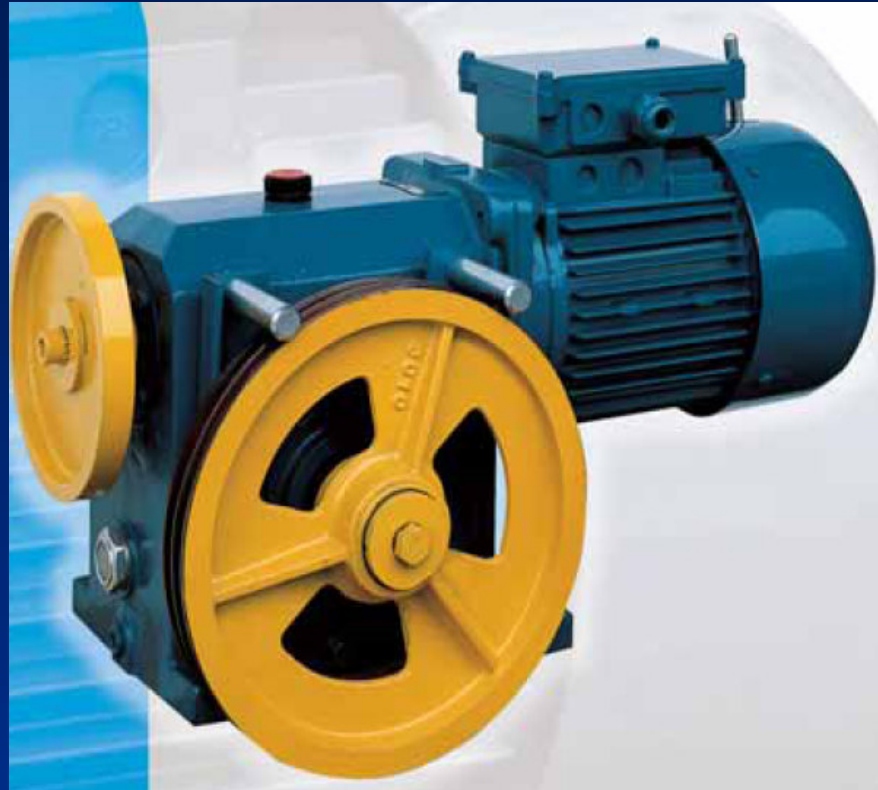

DUMBWAITER

# POSITION

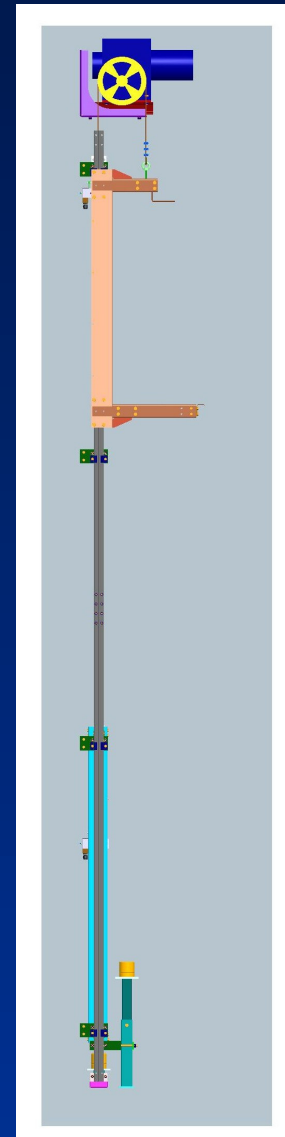
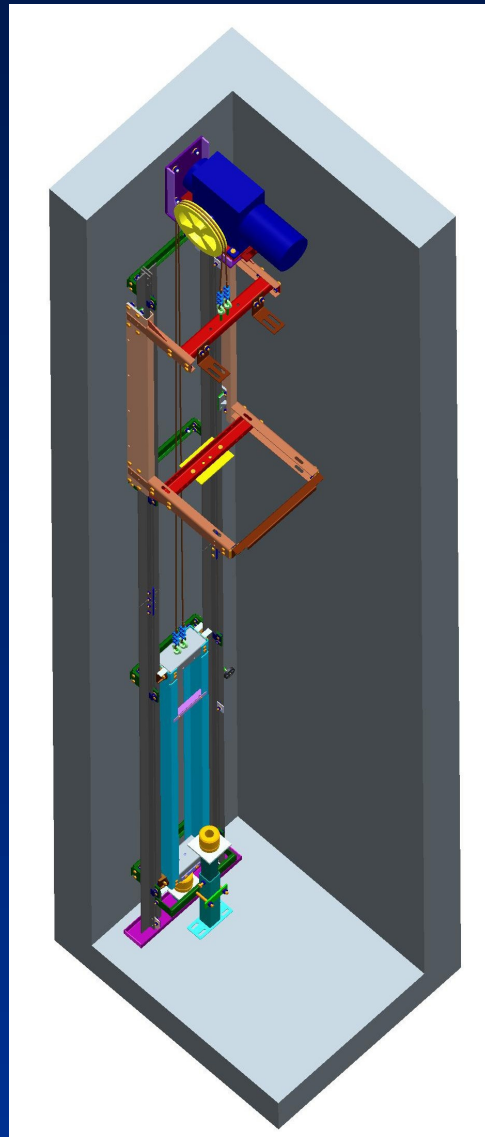
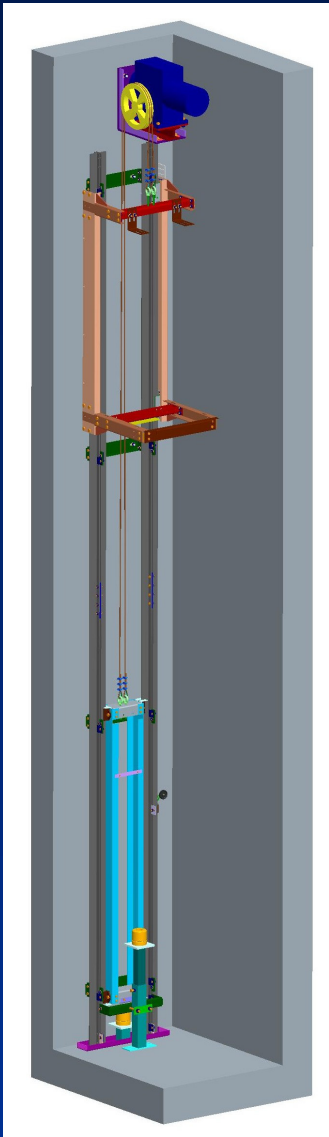

DUMBWAITER

# BRACKET

- One common shaft for cabin's and counterweight's guides.
- Distance from wall 100mm till 115mm.

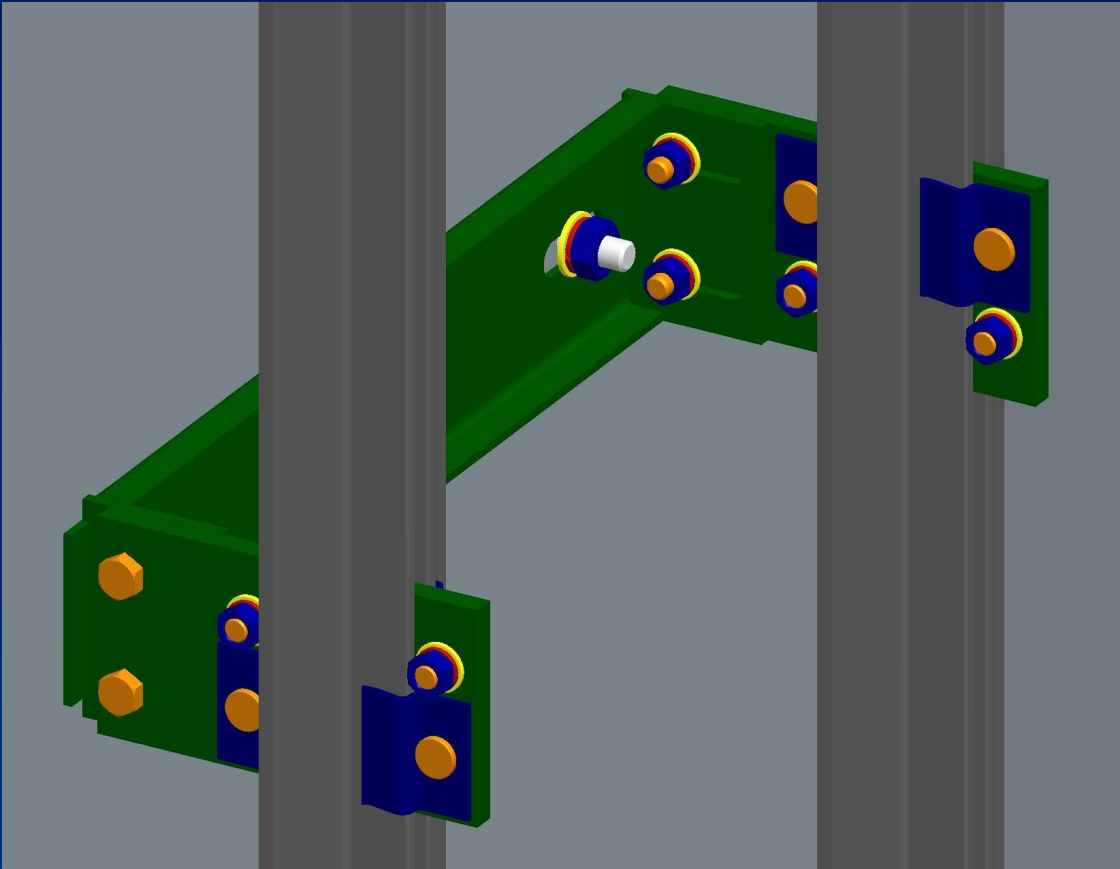

- Brackets every 1500 mm
- DBG = 456 mm
- dbg = 240 mm

# MOTOR BASE

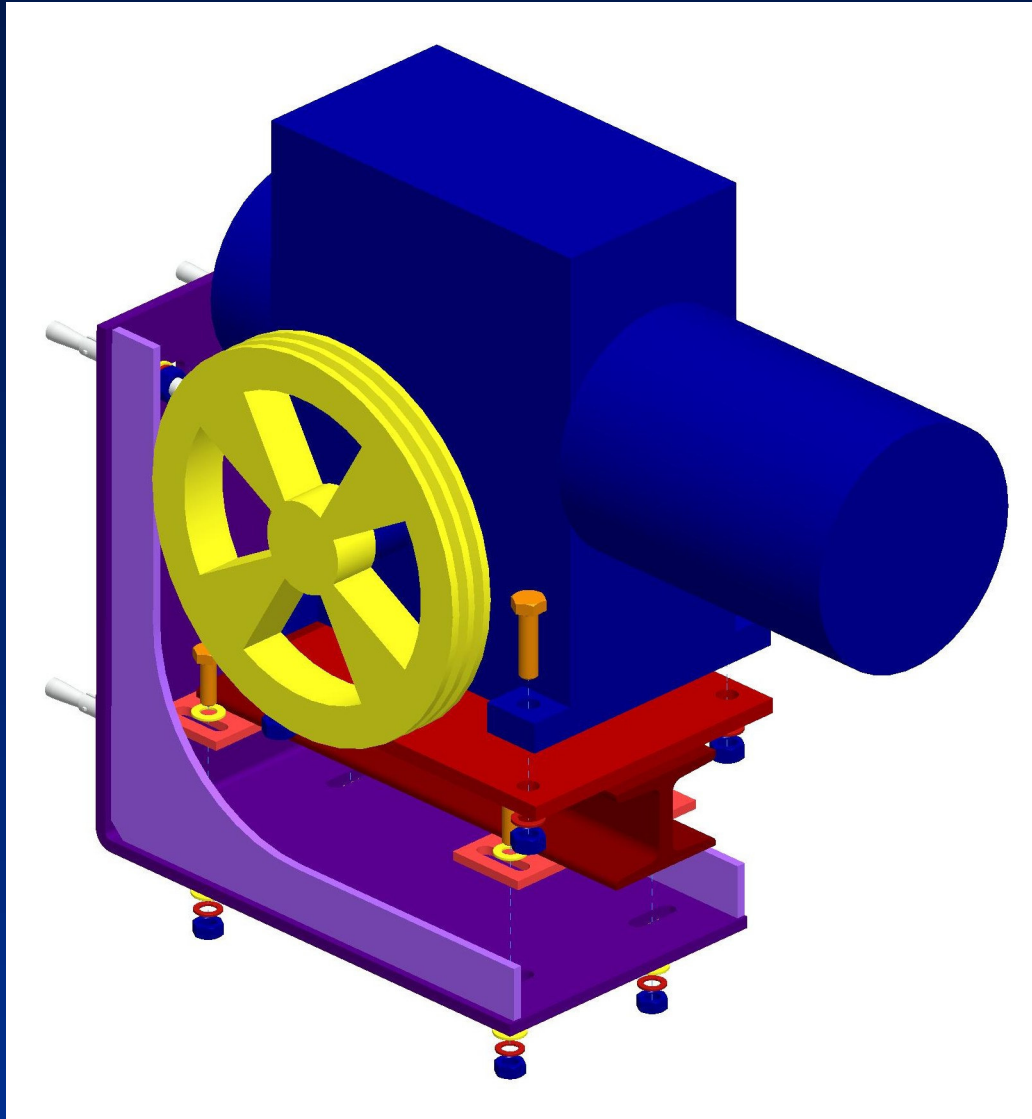

DUMBWAITER

Same base for left or right placement

# FINAL SWITCH

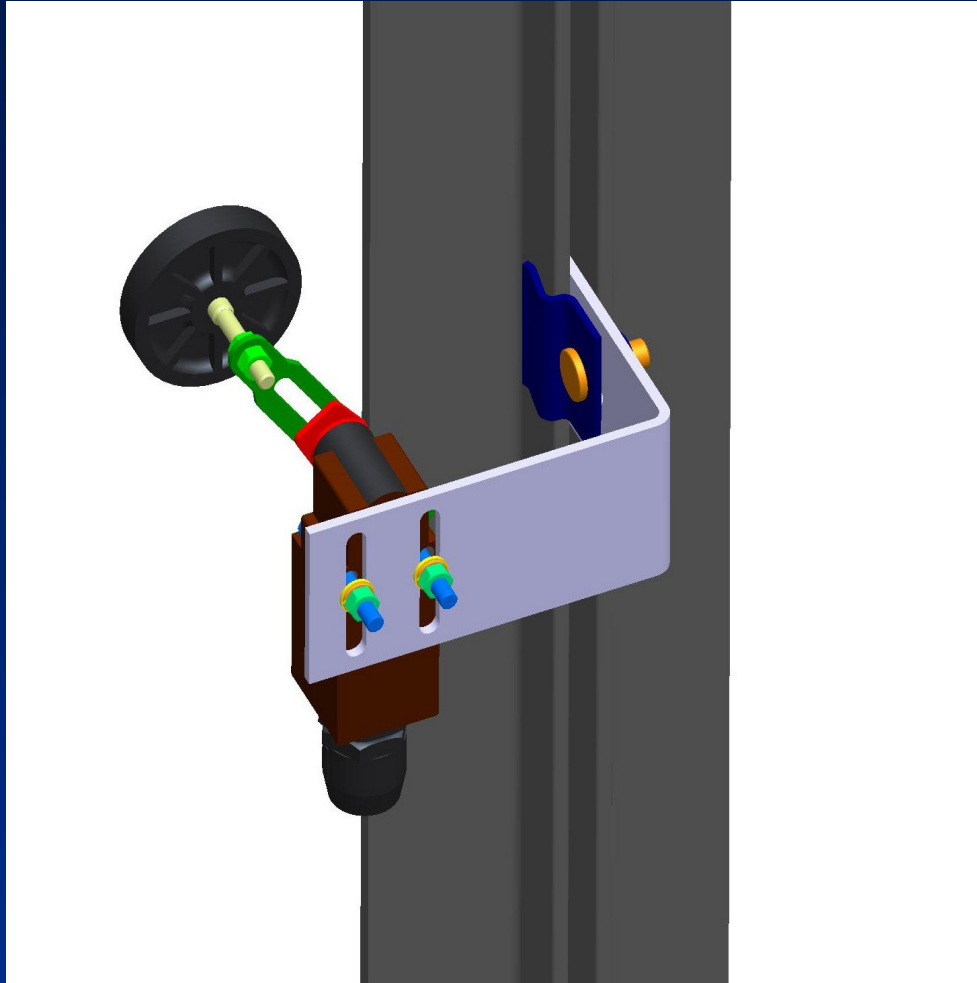

On the guides of the cabin

DUMBWAITER

# LANDING DOORS

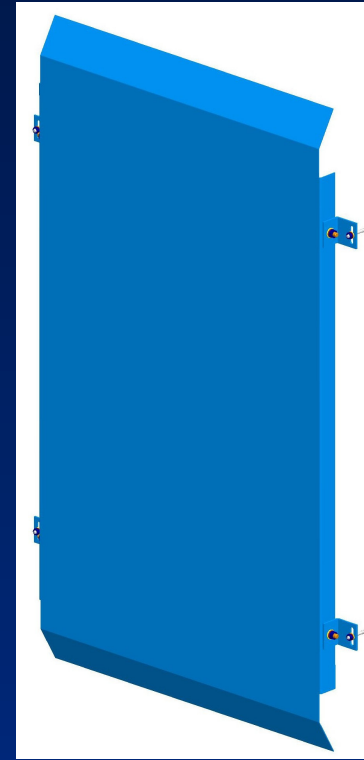
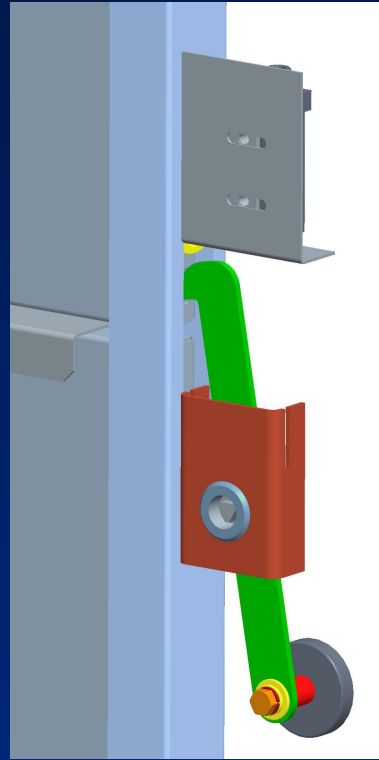
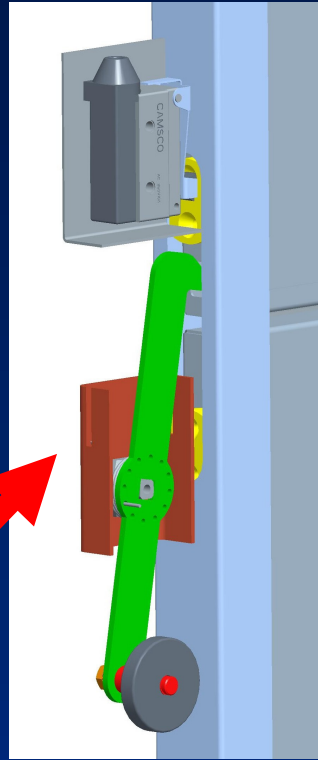
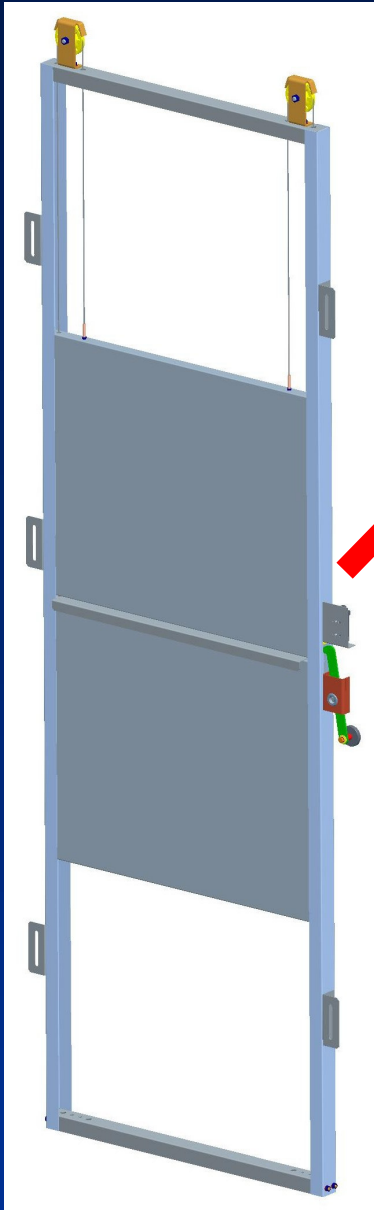

- Guillotine type doors.
- Mechanical and electrical safety. Open also with triangular key.
- Protection sheets



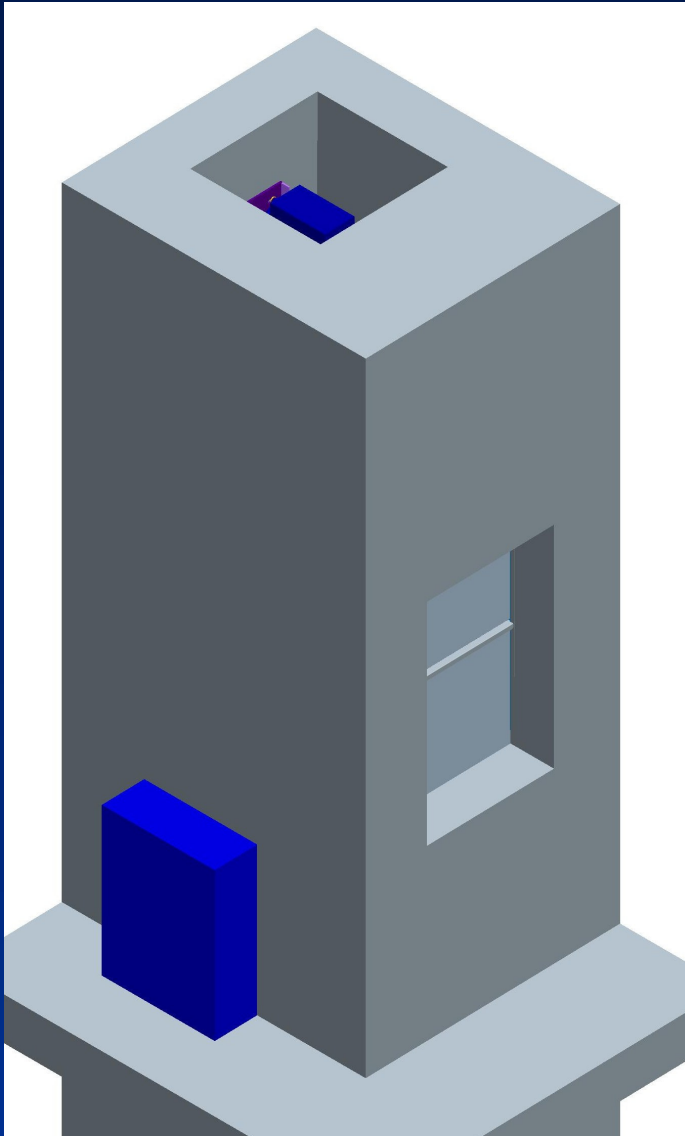

### • INSPECTION HOLE

- Access to Machine.
- In any side of the shaft, even on the roof.
- Suggested dimension 600x600mm.

### • CONTROLLER BOX

- Near the machine
- If possible even inside the shaft.
- Dimensions: 450 x 700 x 190 mm (Width x Height x Depth).